

# Campus Map

Revised 7-1-18

## CLARKSVILLE CAMPUS

Nashville State Community College

1760 Wilma Rudolph Blvd.

931-472-3450

email: [clarksville@nsc.edu](mailto:clarksville@nsc.edu)

[www.nsc.edu/clarksville](http://www.nsc.edu/clarksville)

NSCC 04-19 - NSCC is a TBR institution, AA/EEO employer, and does not discriminate against students, employees, or applicants for admission or employment on the basis of race, color, religion, creed, national origin, sex, sexual orientation, gender identity/expression, disability, age, status as a protected veteran, genetic information, or any other legally protected class with respect to all employment, programs and activities sponsored by NSCC. Inquiries regarding non-discrimination policies: Director of Human Resources, Human.Resources@nsc.edu, 120 White Bridge Road, 615-353-3305.

The Nashville State policy on nondiscrimination can be found at [www.nsc.edu/legal/non-discrimination-policy](http://www.nsc.edu/legal/non-discrimination-policy).  
Printer: NSCC Copy Shop • 120 White Bridge Rd, Nashville, TN 37209 • Qty: 2,500 • © 2018, NSCC.

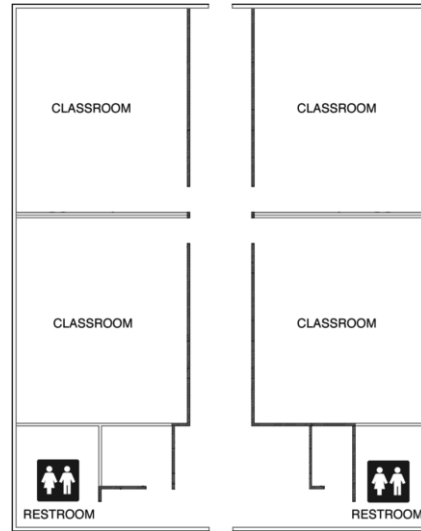

## Modular Building

## Main Building

